



Soneva Fushi



Sunset Retreat

Two bedrooms
Total area 1,290 sqm.

Offering a kitchen, spa, steam room, fitness room, and walk-in minibar, this retreat will make you feel at home.



Some of us are early risers, taking in the dawn and its peaceful atmosphere. And others of us revel in the spirit of the evening, leaving the early hours for the birds. We created the Sunset Retreat more for the latter set – though absolutely everyone will enjoy its luxuries.

With this retreat, we offer you two luxury bungalows of two-storeys each. Incredibly spacious, within its walls and sprawling outdoor spaces you will find balconies with breathtaking views, a raised dining pavilion, wine cellar, steam room, gym and a private swimming pool to float away your cares or splash away in tropical surrender.

All the luxurious details

- Beach front villa
- 2 bungalows with two levels each
- Overhead fan, air conditioning, extensive mini bar and personal safe
- DVD player and Bose Hi-fi system with docking station for personal iPods
- iPods in all villas preloaded with music and movie selection
- Open-air garden bathroom with bathtub, shower and a double sink unit with large over hanging mirror
- Private outside sitting area with sun loungers and direct access to beach
- Bicycles are provided for all villas
- Wi-Fi connection is provided in villa on request
- Mr/Mrs Friday (Butler) service for all villas
- IDD telephones

1st bungalow

- Entrance hall with large walk in storage wardrobe
- Luxurious open-air private garden bathroom
- Large bathtub and separate shower
- Double sink unit with large overhanging mirror
- Spiral staircase in entrance
- Spacious bedroom with king size bed
- Door from bedroom leads to gangway to adjoining villa
- In-villa wine cellar
- Steam room, gym and relaxation area

2nd bungalow

- A large staircase from the study leads down to hallway to main entrance
- Smaller bedroom with separate bathroom
- Large sitting room with daybeds/sofas
- Large study, kitchen and in-villa wine cellar
- A gangway leads over the sitting room and continues into the dining pavilion

Outside

- Private swimming pool
- Dining pavilion above the pool





More images :
<http://www.soneva.com/soneva-fushi/villas/sunset-retreat/>

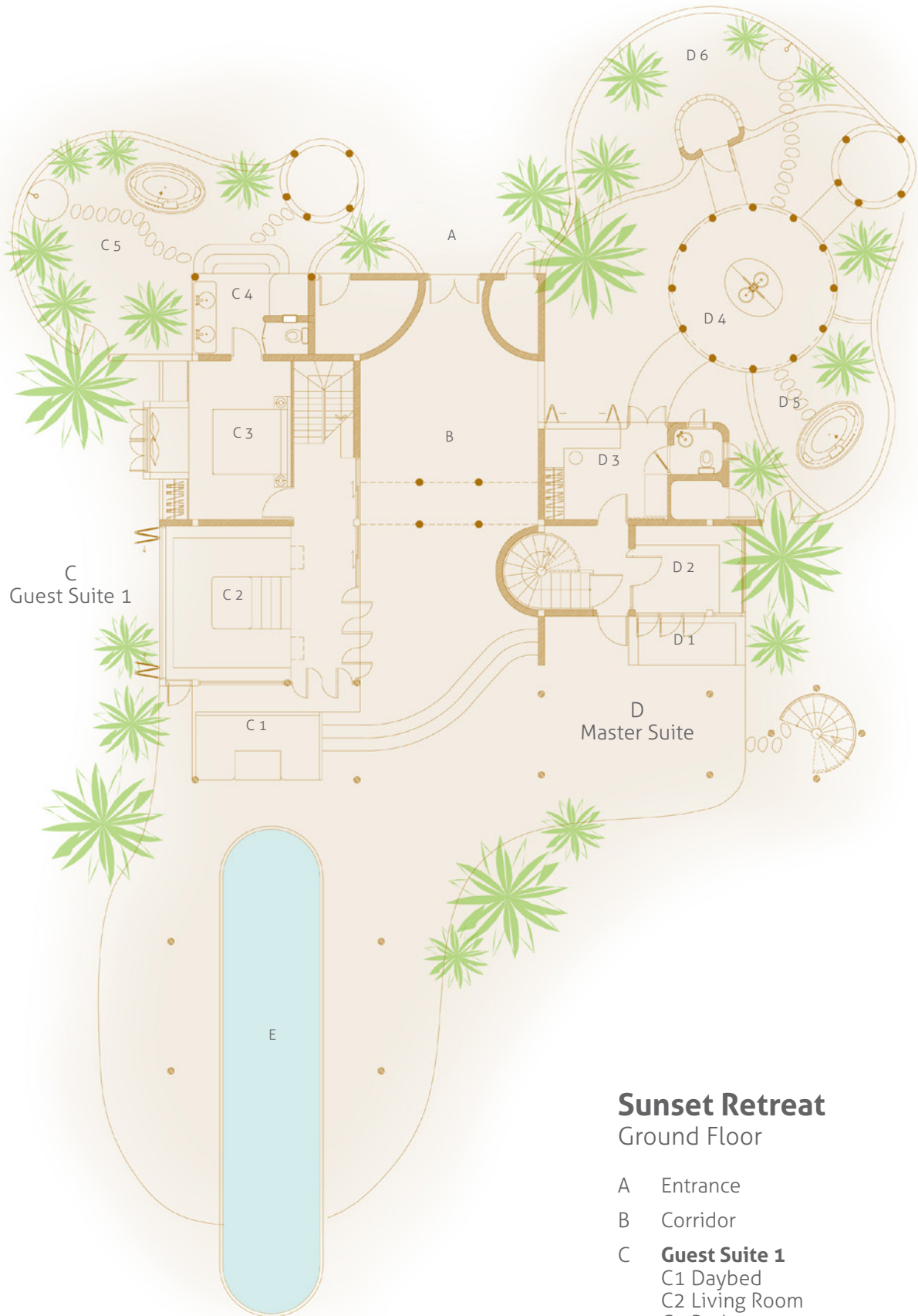

Sunset Retreat

Ground Floor

- A Entrance
- B Corridor
- C **Guest Suite 1**
 - C1 Daybed
 - C2 Living Room
 - C3 Bedroom
 - C4 Bathroom
 - C5 Outdoor Bathroom
- D **Master Suite**
 - D1 Daybed
 - D2 Living Room
 - D3 Dressing Room
 - D4 Bathroom
 - D5 Outdoor Bathtub
 - D6 Outdoor Shower
- E Pool



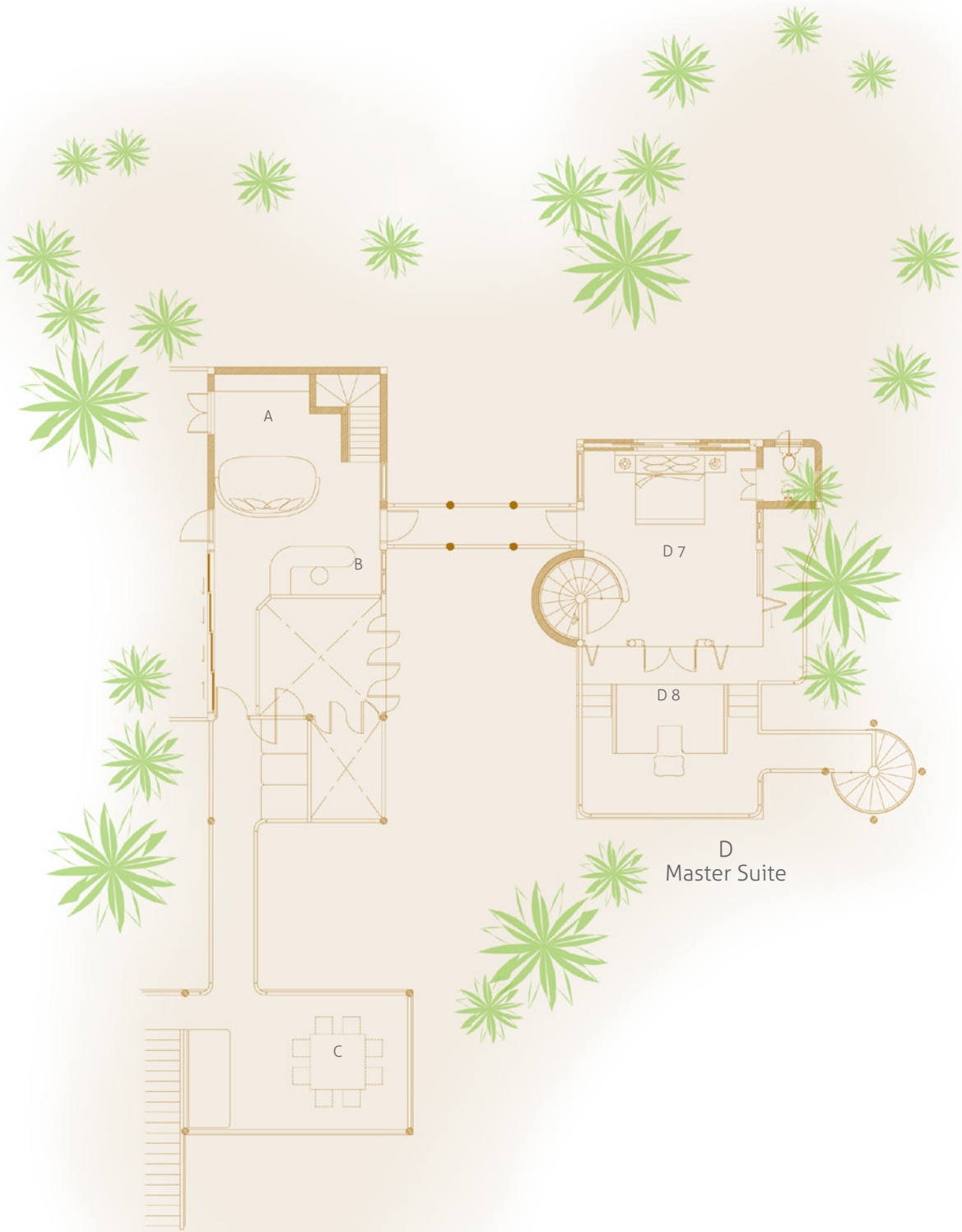

Baa Atoll, Republic of Maldives
 T: +91 124 4511000 | E: reservations@soneva.com

Sunset Retreat

First Floor

- A TV Lounge
- B Minibar
- C Dining Area
- D **Master Suite**
 D7 Bedroom
 D8 Daybed